

Instruction Sheet

Kit Number: 79216100

AIR RIDE SEAT KIT



WARNING: FAILURE TO FOLLOW INSTRUCTIONS could result in personal injury and/or damage to unit.
Read, understand, and follow all safety practices in Operator's Manual before beginning.

PACKAGE CONTENTS

Check the contents of your kit for the parts listed below. Also see Figure 1.

Item	Description	Qty	Ariens P/N
1	Isolator Mount	4	07500213
2	5/16-18 x 1" Hex Bolt	8	05901701
3	11/32 x 11/16 x 1/16" Flat Steel Washer	8	06401017
4	5/16-18" Nylon Locking Flange Nut	12	06500809
5	Seat Plate	1	05197353
6	3/8-16 x 2 1/2" Hex Bolt	4	05943100
7	Seat Retainer	4	04443000
8	Air Ride Seat	1	04875900
9	Seat Recliner Knob with Hardware	1	04976900
10	ISO Seat Mounting Weldment	1	04876953
11	3/8"-16 x 3 1/4" Hex Bolt	2	05901817
12	3/8"-16 Nylon Locking Flange Nut	2	06500726

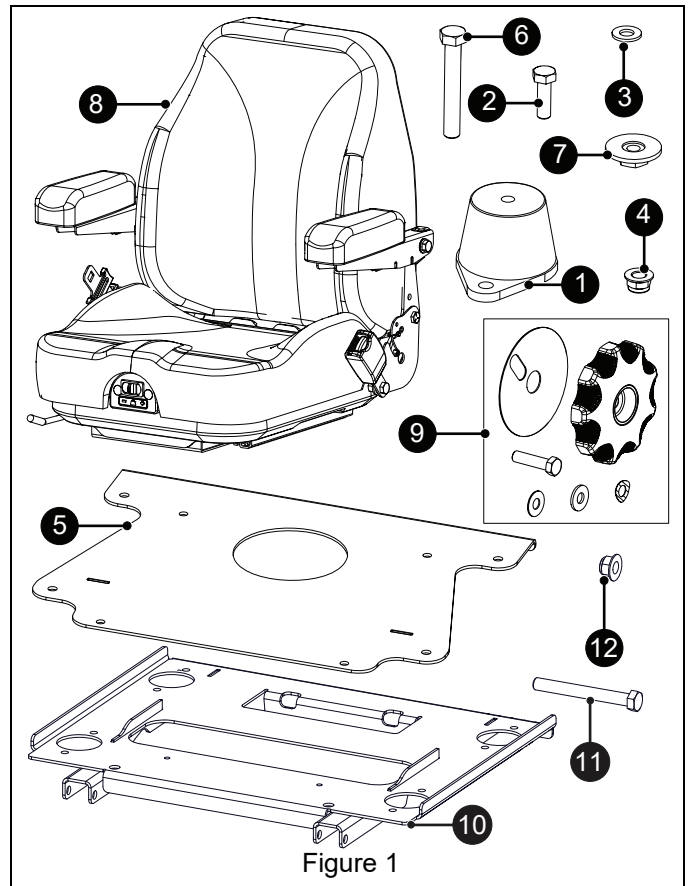
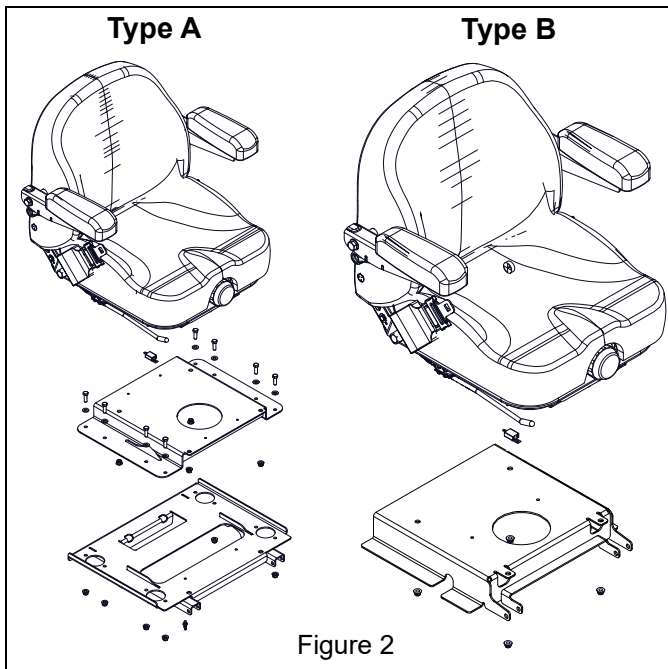

Figure 1

IDENTIFICATION

Mowers have two different style of seat plates depending on build date. An additional mounting weldment is required to mount the air ride seat on type B seat plates.



REMOVAL

Remove Seat Assembly

1. Stop engine, remove key and engage parking brake. Wait for moving parts to stop and for hot parts to cool.
2. Move steering levers outward and rotate seat to service position.
3. Disconnect negative battery cable.
4. Remove cable tie tree from seat mounting plate bottom and disconnect adapter from wire harness. See Figure 3.

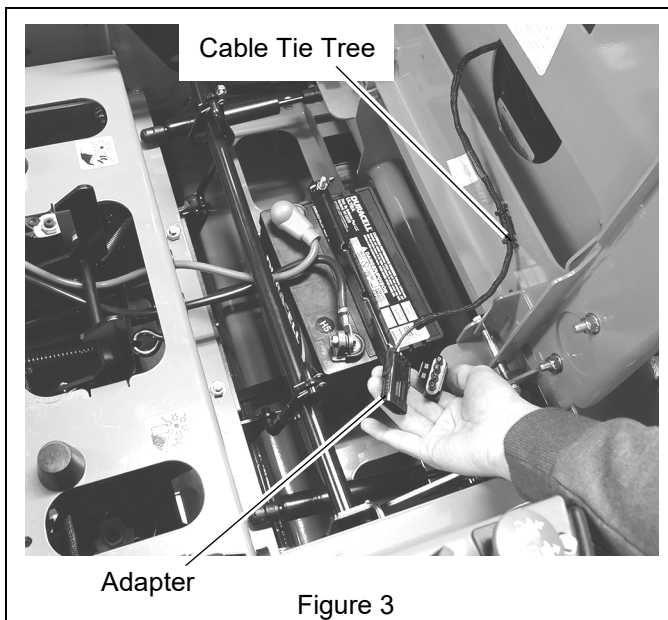

CAUTION: AVOID INJURY. Seat assembly is heavy. Use a capable helper and support seat when removing assembly.

5. Remove and discard hardware securing seat mounting plate to seat mounting bracket. See Figure 4.

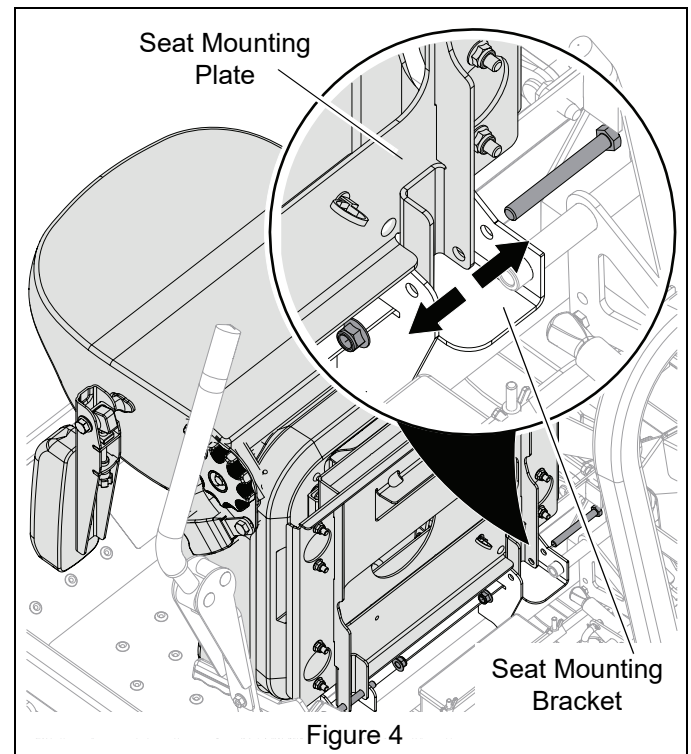

6. Remove seat assembly and place on a clean, protective surface.

NOTICE: Seat upholstery can tear. DO NOT place seat on or near sharp objects.

Remove Seat Plate (Type A Only)

1. Remove and discard hardware securing seat mounting plate to seat base. Discard seat mounting plate. See Figure 5.

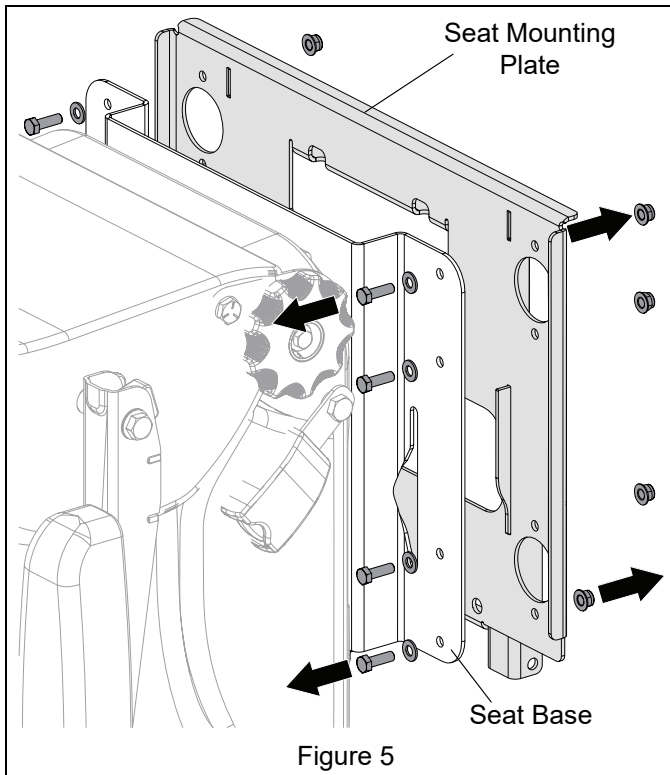

Remove Seat Base

1. Remove hardware retaining seat base and discard. See Figure 6.

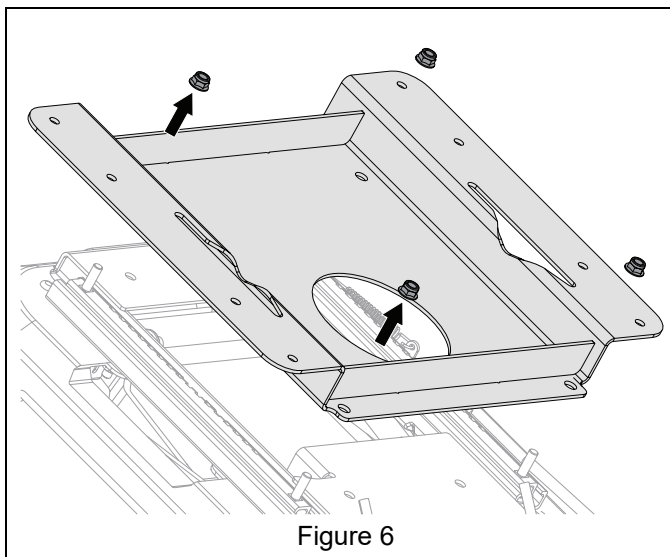

2. If retaining seat, store in a cool, dry location.

INSTALLATION

1. Place air ride seat (item 8) onto clean, protective surface. Position so seat bottom is accessible. See Figure 7.
2. Install four isolator mounts (item 1) onto seat plate (item 5) with four 3/8 x 2 1/2" hex bolts (item 6).

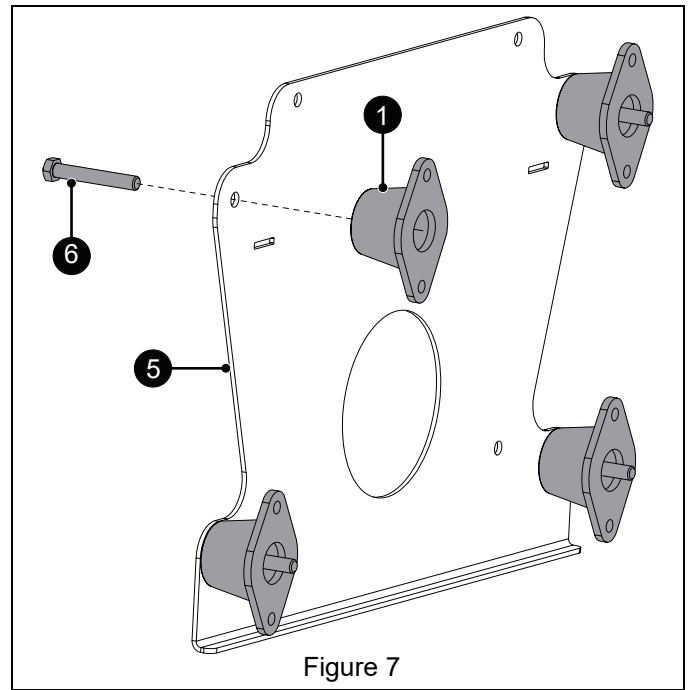

3. Install seat plate assembly onto air ride seat (item 8) and secure with four 5/16" nyloc locking flange nuts (item 4). See Figure 8.

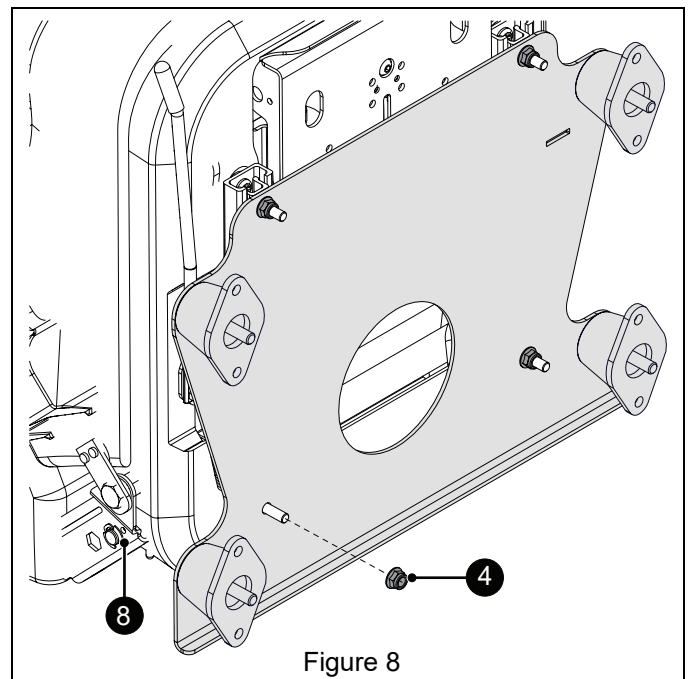

- Secure seat mounting plate (item 10) to isolator mounts with eight 5/16 x 1" hex bolts (item 2), eight 1/16" flat steel washers (item 3) and eight 5/16" nylon locking flange nuts (item 4). See Figure 9.

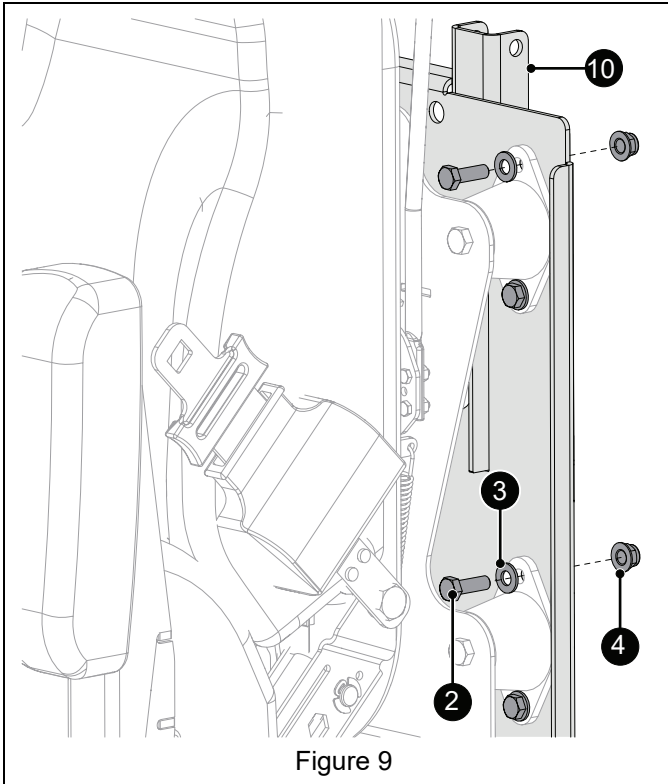

CAUTION: AVOID INJURY. Seat assembly is heavy. Use two people to install.

- With assistance from a capable helper, align seat mounting plate with seat mounting bracket and secure with two 3/8 x 3 1/4" hex bolts (item 11) and two 3/8" nyloc locking flange nuts (item 12). See Figure 11.

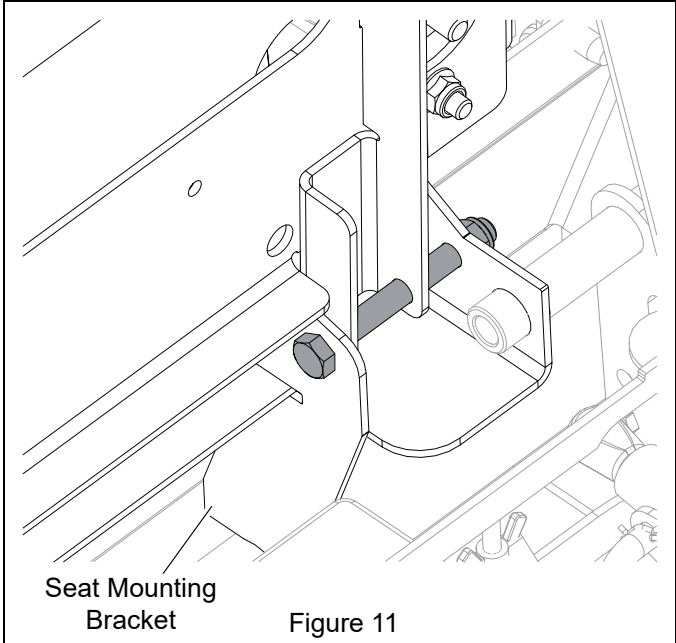

- Install four seat retainers (item 7) onto 3/8 x 2 1/2" hex bolts through isolator mounts and tighten until retainer nut contacts isolators. DO NOT overtighten. See Figure 10.

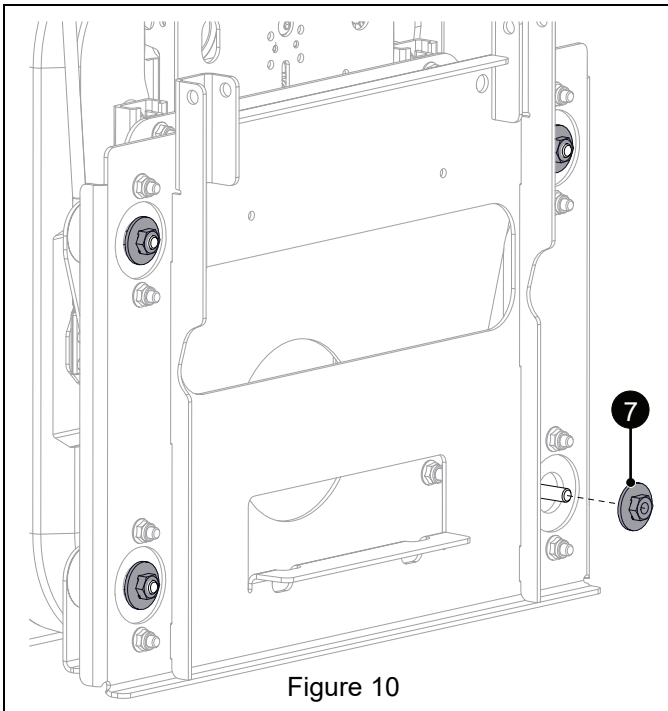

- Route seat cables through slot in seat mounting plate. Insert cable tie trees into holes in seat mounting plate. See Figure 12.

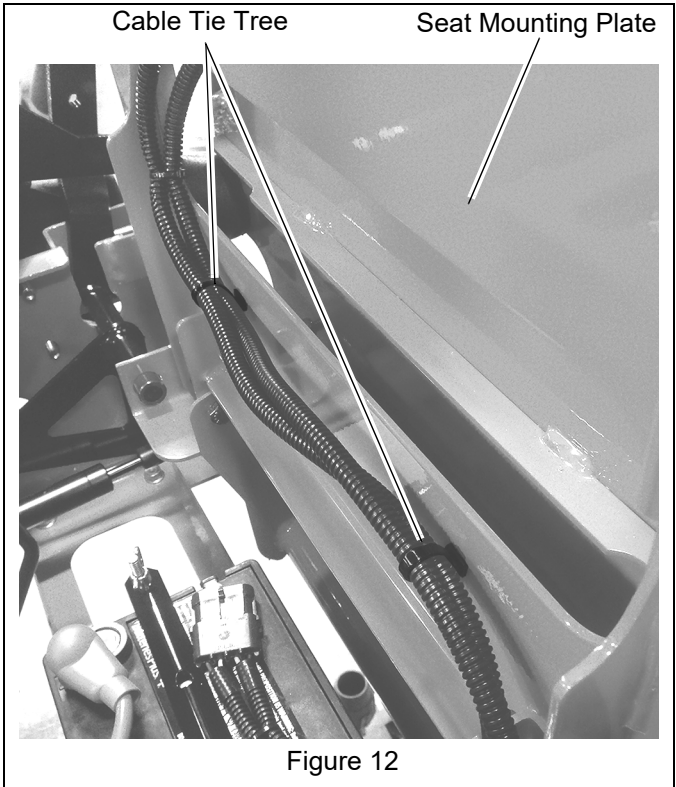

8. Reconnect seat wire adapter to wire harness. See Figure 13.

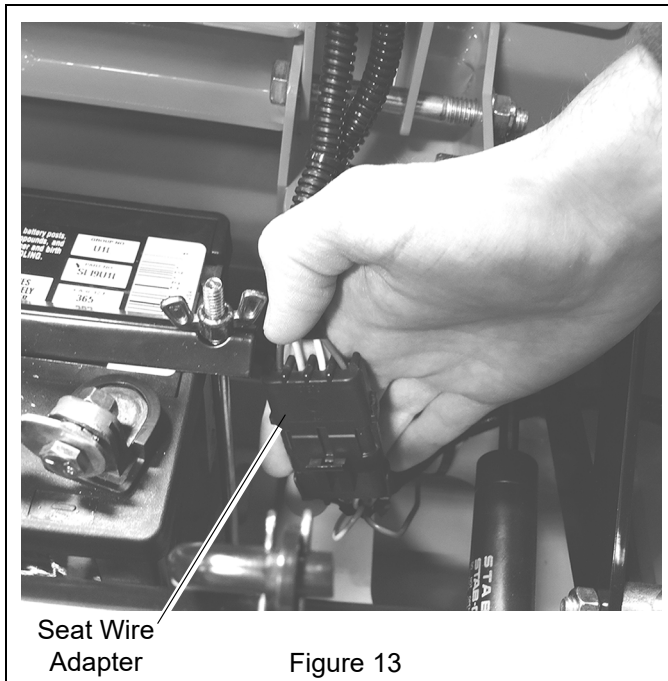

9. Reconnect negative battery cable.
10. Return seat and steering levers to operating position.
11. Remove hairpin from clevis pin and remove clevis pin. See Figure 14.

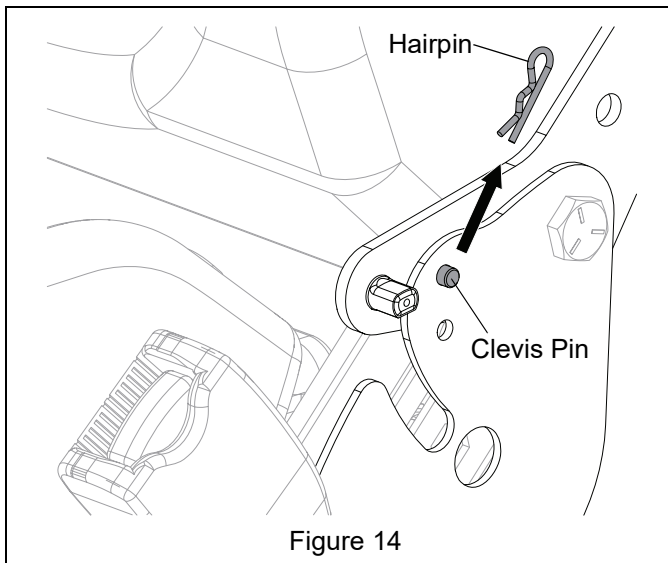

See Figure 15.

12. Rotate seat forward so top edge of seat cushion bracket is below lower hole in seat plate.
13. Reinstall clevis pin through lower hole in seat plate and secure with hairpin.

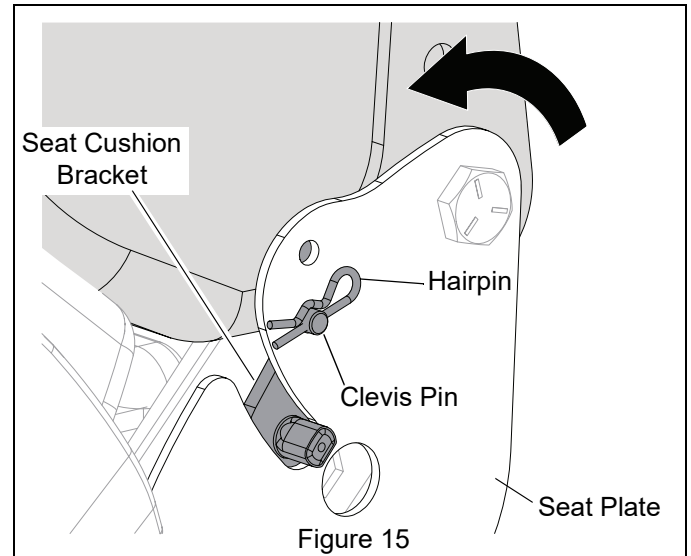

See Figure 16.

NOTICE: Seat recliner knob (item 9) is packaged in bag, unassembled. Steps 14 – 16 use bag contents.

14. Align slot in knob plate with seat reclining pin and install plate over pin.
15. Install one wave washer, flat steel washer and flat special washer onto hex bolt.
16. Insert hex bolt through seat recliner knob and install knob onto seat. Tighten bolt until snug, but **DO NOT** overtighten. Knob **MUST** be able to turn easily.

